

Capacitor Mounting Solutions

Mounting Brackets for Cylindrical Capacitors up to 85mm

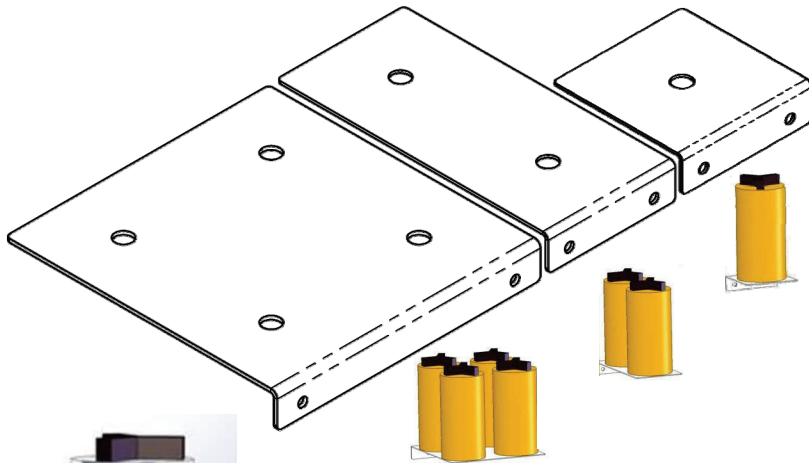

Capacitor Mounting Brackets make it easy to add (85mm) power factor capacitor inside of the motor control cabinet, where it is needed. This enables the PF capacitors to be switched on/off by the motor starter and eliminates the need for capacitor fuses or an additional switch. These “L” brackets can help you to achieve a convenient and low cost means of adding power factor capacitors to your individual motors. For use with cylindrical PF capacitors having a single mounting stud (1/2” hole provided as standard).



Ideal For:

- New Production
- Capacitor Replacement
- Power Factor Correction at the Motor
- More...

Capacitor Mounting Brackets				
Cat. No.	# of Capacitors	Length	Width	Height
BL-1	1	3.75”	3.75”	1.00”
BL-2	2	8.0”	3.75”	1.00”
BL-4	3-4	8.0”	7.75”	1.00”

Adaptor Brackets for Replacing Rectangular Capacitors with Cylindrical Capacitors

Capacitor Adaptor Brackets enable you to conveniently replace the older type rectangular power factor or filter capacitors with present type cylindrical capacitors. Rectangular capacitors were typically secured by two bolts on the sides of the capacitor, whereas contemporary capacitors use single hole mounting (1/2” hole provided). Simply attach cylindrical capacitor to the adaptor bracket then bolt the bracket using existing side slots. Wire the replacement capacitor in place.

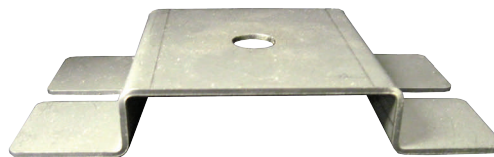

Capacitor Adaptor Bracket

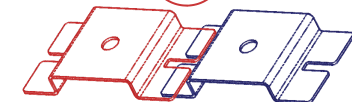
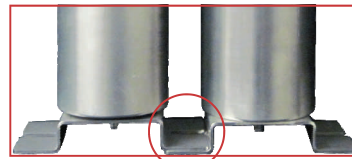

Brackets Can Be Overlapped



Capacitor Adaptor Bracket			
Cat. No.	Length	Width	Height
BA-1	5.50”	3.00”	.78”



GenMet Corporation
10245 W. Enterprise Drive
Mequon, WI 53092



www.genmet.com
Email: info@genmet.com
Phone: 1-262-238-7000
Fax: 1-262-238-7007